

Motor 6 - SLATERS 7L002 (A-B-C)

E3-A. Drg 6 9/85

Manufactured by Slaters.

Supplied fitted with a Faulhaber 2233-012S motor.

Motor details: Nominal voltage - 12 volts. No load speed - 8500 rpm. Maximum recommended current - 0.25 amps. Maximum recommended speed - 8000 rpm. Stalled torque - 168 gram cm.

Gearbox details: This consists of two separate sections. The first section spur gearbox has a reduction of 20.25:1 with an efficiency of 73%, and the second section is a 1:1 set of crossed helical gears with an efficiency of 75%. Overall reduction 20.25:1. Overall efficiency - 55%. Driving axle speed - 420 rpm.

Comment: This combination gives a good tractive effort at all speeds. Suitable for most locomotive types.

Data Source: Manufacturer's data sheet.

Available from Slaters, Temple Road, Matlock Bath, Derbyshire.

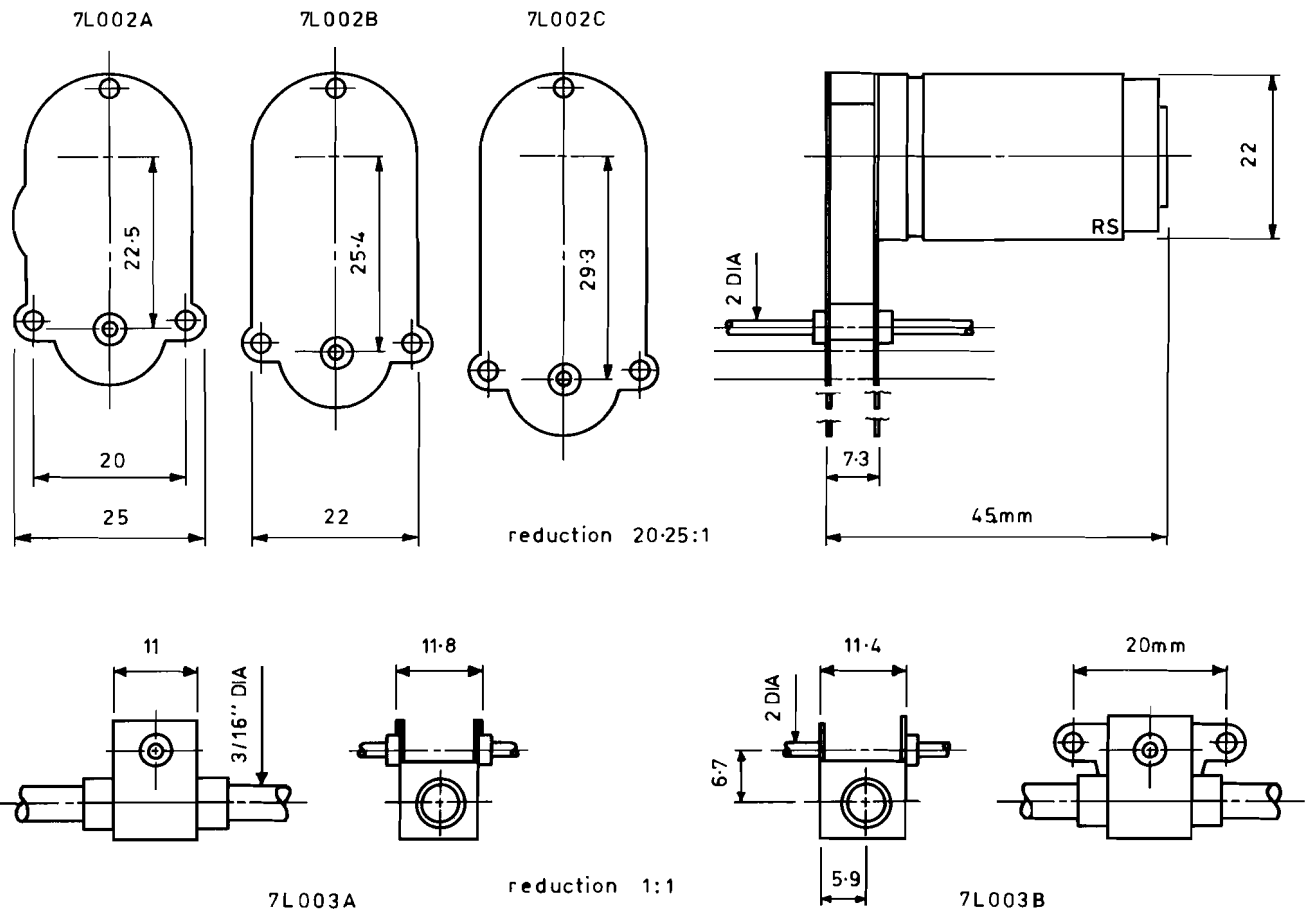

SEE REVERSE FOR GRAPH

